

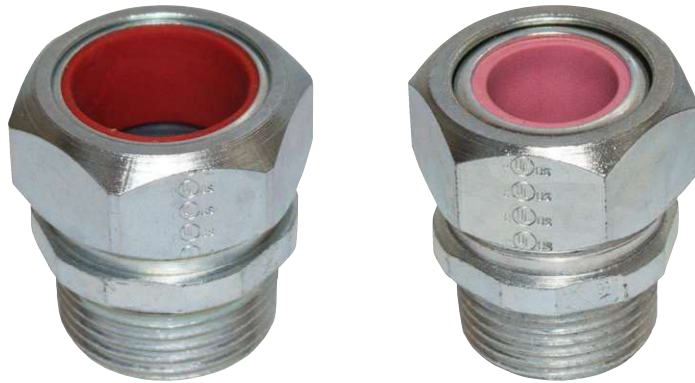

STRAIGHT STEEL CORD GRIPS



Suitable for use in Hazardous Locations
Class I, Division 2, Class II, Divisions
1 & 2, Class III, Divisions 1 & 2 per the
NEC 501-4(b), 505-4(a), 503-3(a)

UL514B

NEMA FB-1

Type Ratings: 4, 4X, 5, 6, 6P, 12, 12K, 13

 - File E22698



FEATURES-SPECIFICATIONS

Features

- Neoprene grommet seals out oil and moisture
- Unique color-coded grommets for easy cord range identification
- Provides a liquid tight and strain relief termination for flexible type, neoprene, vinyl, or PVC control cord and cable
- Wider and more compression cable ranges to encompass and accommodate specification projects
- Smaller overall profile for the most compact installation
- Cord and Cable Type
 - » S, SO, ST & STO
- Made in the USA

Materials

- Steel/malleable iron
- Zinc electro-plated
- Natural Finish

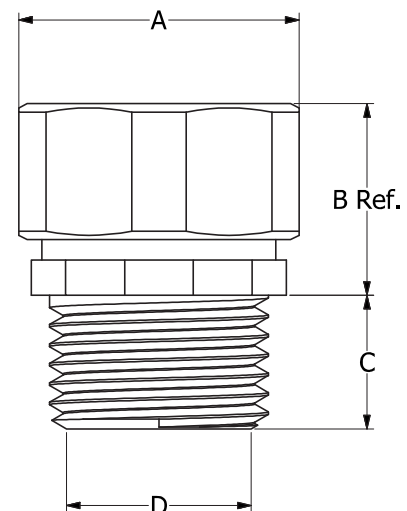



FITTINGS
CG SERIES

STRAIGHT STEEL CORD GRIPS

CG CORD CONNECTORS - STRAIGHT								
CATALOG NUMBER	NPT SIZE	CORD RANGES INCHES (MM)	COLOR CODE	DIMENSIONS INCHES (MM)				
				A		B	C	D
				A/C	A/F			
CG1238S	3/8"	.125"-.187" (3.175-4.75)	Red	.94" (23.8)	.875" (22.2)	.88" (22.4)	.44" (11.2)	.44" (11.2)
CG1838S	3/8"	.187"-.312" (4.75-7.92)	Brown	.94" (23.8)	.875" (22.2)	.88" (22.4)	.44" (11.2)	.44" (11.2)
CG3138S	3/8"	.312"-.437" (7.92-12.01)	Yellow	.94" (23.8)	.875" (22.2)	.88" (22.4)	.44" (11.2)	.44" (11.2)
CG31501S	1/2"	.312"-.473" (7.92-12.01)	Yellow	.94" (23.8)	.875" (22.2)	.88" (22.4)	.50" (12.7)	.44" (11.2)
CG1250S	1/2"	.125"-.187" (3.175-4.75)	Red	1.09" (27.8)	1.03" (26.2)	.81" (20.6)	.50" (12.7)	.44" (11.2)
CG1850S	1/2"	.187"-.312" (4.75-7.92)	Brown	1.09" (27.8)	1.03" (26.2)	.81" (20.6)	.50" (12.7)	.63" (15.9)
CG3150S	1/2"	.312"-.437" (7.92-12.01)	Yellow	1.09" (27.8)	1.03" (26.2)	.81" (20.6)	.50" (12.7)	.63" (15.9)
CG3750S	1/2"	.375"-.500" (9.525-12.7)	Purple	1.09" (27.8)	1.03" (26.2)	.81" (20.6)	.50" (12.7)	.63" (15.9)
CG5050S	1/2"	.500"-.625" (12.7-15.88)	Pink	1.09" (27.8)	1.03" (26.2)	.81" (20.6)	.50" (12.7)	.63" (15.9)
CG6250S	1/2"	.625"-.750" (15.88-19.05)	Orange	1.09" (27.8)	1.03" (26.2)	.81" (20.6)	.50" (12.7)	.56" (14.3)
CG1275S	3/4"	.125"-.250" (3.175-6.35)	Blue	1.31" (33.3)	1.28" (32.5)	1.09" (27.7)	.53" (13.5)	.75" (19.1)
CG2575S	3/4"	.250"-.375" (6.35-9.525)	Green	1.31" (33.3)	1.28" (32.5)	1.09" (27.7)	.53" (13.5)	.75" (19.1)
CG3775S	3/4"	.375"-.500" (9.525-12.7)	Purple	1.31" (33.3)	1.28" (32.5)	1.09" (27.7)	.53" (13.5)	.75" (19.1)
CG5075S	3/4"	.500"-.625" (12.7-15.88)	Pink	1.31" (33.3)	1.28" (32.5)	1.09" (27.7)	.53" (13.5)	.75" (19.1)
CG6275S	3/4"	.625"-.750" (15.88-19.05)	Orange	1.31" (33.3)	1.28" (32.5)	1.09" (27.7)	.53" (13.5)	.75" (19.1)
CG7575S	3/4"	.750"-.875" (19.05-22.23)	Gray	1.31" (33.3)	1.28" (32.5)	1.09" (27.7)	.53" (13.5)	.75" (19.1)
CG37100S	1"	.375"-.500" (9.525-12.7)	Purple	1.31" (33.3)	1.28" (32.5)	1.06" (26.9)	.69" (17.5)	.88" (22.4)
CG50100S	1"	.500"-.625" (12.7-15.88)	Pink	1.31" (33.3)	1.28" (32.5)	1.06" (26.9)	.69" (17.5)	.88" (22.4)
CG62100S	1"	.625"-.750" (15.88-19.05)	Orange	1.31" (33.3)	1.28" (32.5)	1.06" (26.9)	.69" (17.5)	.88" (22.4)
CG75100S	1"	.750"-.875" (19.05-22.23)	Gray	1.31" (33.3)	1.28" (32.5)	1.06" (26.9)	.69" (17.5)	1.00" (25.4)
CG87100S	1"	.875"-1.000" (22.23-25.4)	Red	1.63" (41.3)	1.56" (39.6)	1.19" (30.2)	.69" (17.5)	1.00" (25.4)
CG100100S	1"	1.000"-1.125" (25.4-28.58)	Blue	1.63" (41.3)	1.56" (39.6)	1.19" (30.2)	.69" (17.5)	1.00" (25.4)
CG87125S	1-1/4"	.750"-.875" (19.05-22.23)	Gray	1.63" (41.3)	1.56" (39.6)	1.19" (30.2)	.69" (17.5)	1.06" (26.9)
CG87125S	1-1/4"	.875"-1.000" (22.23-25.4)	Red	1.63" (41.3)	1.56" (39.6)	1.19" (30.2)	.69" (17.5)	1.06" (26.9)
CG100125S	1-1/4"	1.000"-1.125" (25.4-28.58)	Blue	1.63" (41.3)	1.56" (39.6)	1.19" (30.2)	.69" (17.5)	1.31" (33.3)
CG112125S	1-1/4"	1.125"-1.250" (28.58-31.75)	Brown	2.03" (51.6)	1.94" (49.3)	1.19" (30.2)	.69" (17.5)	1.31" (33.3)
CG125125S	1-1/4"	1.250"-1.375" (31.75-34.93)	Green	2.03" (51.6)	1.94" (49.3)	1.25" (31.8)	.69" (17.5)	1.31" (33.3)
CG137125S	1-1/4"	1.375"-1.500" (34.93-38.10)	Yellow	2.03" (51.6)	1.94" (49.3)	1.25" (31.8)	.69" (17.5)	1.31" (33.3)
CG115150S	1-1/2"	1.156"-1.312" (29.36-33.32)	Purple	2.38" (60.3)	2.28" (57.9)	1.53" (38.9)	.72" (18.3)	1.62" (41.3)
CG128150S	1-1/2"	1.281"-1.531" (32.54-38.89)	Pink	2.38" (60.3)	2.28" (57.9)	1.53" (38.9)	.72" (18.3)	1.62" (41.3)
CG153200S	2"	1.531"-1.780" (38.89-45.21)	Orange	2.38" (60.3)	2.28" (57.9)	1.78" (45.2)	.72" (18.3)	1.94" (49.3)
CG2060200S	2"	1.940"-2.060" (49.28-52.32)	Orange	2.38" (60.3)	2.28" (57.9)	1.78" (45.2)	.72" (18.3)	1.94" (49.3)
CG1965250S	2-1/2"	1.750"-1.965" (44.45-49.91)	White	3.375 (85.73)	3.25 (82.55)	1.875 (47.63)	1.125 (28.58)	2.438 (61.93)
CG2187250S	2-1/2"	1.937"-2.187" (49.92-55.55)	Orange	3.375 (85.73)	3.25 (82.55)	1.875 (47.63)	1.125 (28.58)	2.438 (61.93)
CG2360250S	2-1/2"	2.156"-2.360" (54.76-59.94)	Brown	3.375 (85.73)	3.25 (82.55)	1.875 (47.63)	1.125 (28.58)	2.438 (61.93)
CG2565250S	2-1/2"	2.350"-2.565" (59.69-65.15)	Green	3.375 (85.73)	3.25 (82.55)	1.875 (47.63)	1.125 (28.58)	2.438 (61.93)
CG2365300S	3"	2.150"-2.365" (54.61-60.07)	Brown	4" (101.6)	3.938" (101.17)	2.188 (55.56)	1.125 (28.58)	2.938" (74.63)
CG2755300S	3"	2.350"-2.565" (59.69-65.15)	Blue	4" (101.6)	3.938" (101.17)	2.188 (55.56)	1.125 (28.58)	2.938" (74.63)
CG2985300S	3"	2.540"-2.985" (64.51-75.82)	Gray	4" (101.6)	3.938" (101.17)	2.188 (55.56)	1.125 (28.58)	2.938" (74.63)
CG3220300S	3"	2.995"-3.220" (76.07-81.79)	Yellow	4" (101.6)	3.938" (101.17)	2.188 (55.56)	1.125 (28.58)	2.938" (74.63)

- Locknuts sold separately

